

# ARENA TORQUAY

## HIREPACK 2026



[info@arenatorquay.com](mailto:info@arenatorquay.com)



[www.arenatorquay.com](http://www.arenatorquay.com)

# CONTENTS



VENUE  
INFORMATION



FLOOR PLAN,  
DIMENSIONS &  
VISUALS



TECH SPEC



LOAD-IN &  
OUT



CONTACT  
INFORMATION



WHATS  
NEARBY?



GETTING HERE



ARTIST & CREW  
FACILITIES



RATES



## CAPACITY

**Standing: 1200 (including staff, artists & crew)**

*Recommended saleable capacity 1175 (if you wish to change our mix position this will reduce to 1125)*

**Theatre Seated: 450**

**Banquet & Bierkeller Style: 330**

## DOOR & CURFEW

Door times are as per your requirements; however, please note our standard door time for concerts is **7.00pm** with a **12.00am** noise curfew for live music and **01:00am** for DJ's & recorded music.

## LICENSE

Our alcohol license is until **01:30am**.

## AGE RESTRICTIONS

The venue welcomes all ages to its events but please note that **Under 14s** must be accompanied by a parent or legal guardian at all times.

Our license stipulates that all **under 18's** must vacate the premises by **11pm**

## VENUE INFORMATION

### TICKETING

We sell e-tickets via seetickets

Tickets may also be made available on the door via our EPOS system for each event if they are not already sold out online.

**Arena Torquay, 39-41 Torwood Street,  
Torquay, TQ1 1DZ**

**On line:** [www.arenatorquay.com](http://www.arenatorquay.com)

The venue requires a minimum of a **50% allocation** of the saleable capacity.

### PRODUCTION OFFICE

We have a production office with private access in our back of house with wired internet connection.

## SPECIAL EFFECTS

Smoke & haze may be used freely. Pyrotechnics & lasers may only be used by prior arrangement a minimum of **4 working weeks** prior to the performance date(s).

We will require both method statement, proof of insurance and risk assessments for our records, all operators must be deemed competent. Where appropriate we will have to consult Torbay council for clearance.

## MERCHANDISE

Please note we do not charge a merch fee at Arena Torquay. We will provide tables, we can also arrange sellers if requested in advance at **£18.00 per hour + VAT.**

## RIDER

Rider can be provided through our suppliers for hires or split deals at cost price. Please let us know all of your rider requirements in writing to be agreed prior to signing our contract of engagement.

## VENUE INFORMATION

### DE-RIG CHARGES

Please note that when our house PA or lighting is required to be removed to facilitate touring production or a different mix position needs to be set-up we will levy a de-rig charge at cost price to your show to cover removal & reinstatement works.

### PRODUCTION PARKING

There is plenty of paid parking available at both the front and rear of the venue which becomes free parking after 6pm.

The Load in doors are at the rear of the venue on Torwood Gardens Road. This road is wide enough for tour buses, trailers and production vehicles to mount the curb outside our premises.

Coach power (**32A 3-phase**) is available at both the rear and front of the venue. Please Bear in mind not to obstruct any of our fire doors with vans, coaches or trailers. Our power is located on double yellow lines but we will pay any parking charges received.

### DIMENSIONS:

**VENUE CROWD AREA:** 325m<sup>2</sup>

**STAGE:** 9m W x 5m D X 0.75m H

**LIVE LOUNGE BAR:** 200m<sup>2</sup>

**MIX POSITION:** 6.7m<sup>2</sup>

**DRESSING ROOMS X3:** 15m<sup>2</sup>  
(Downstairs - accessed from stage right)

**GREEN ROOM:** 21m<sup>2</sup> (approx)  
(Downstairs - accessed from stage right)

**PRODUCTION OFFICE:**  
6m<sup>2</sup> approx (Downstairs - accessed from stage right)

**LOAD IN LIFT:** 2m<sup>2</sup> 500kg max

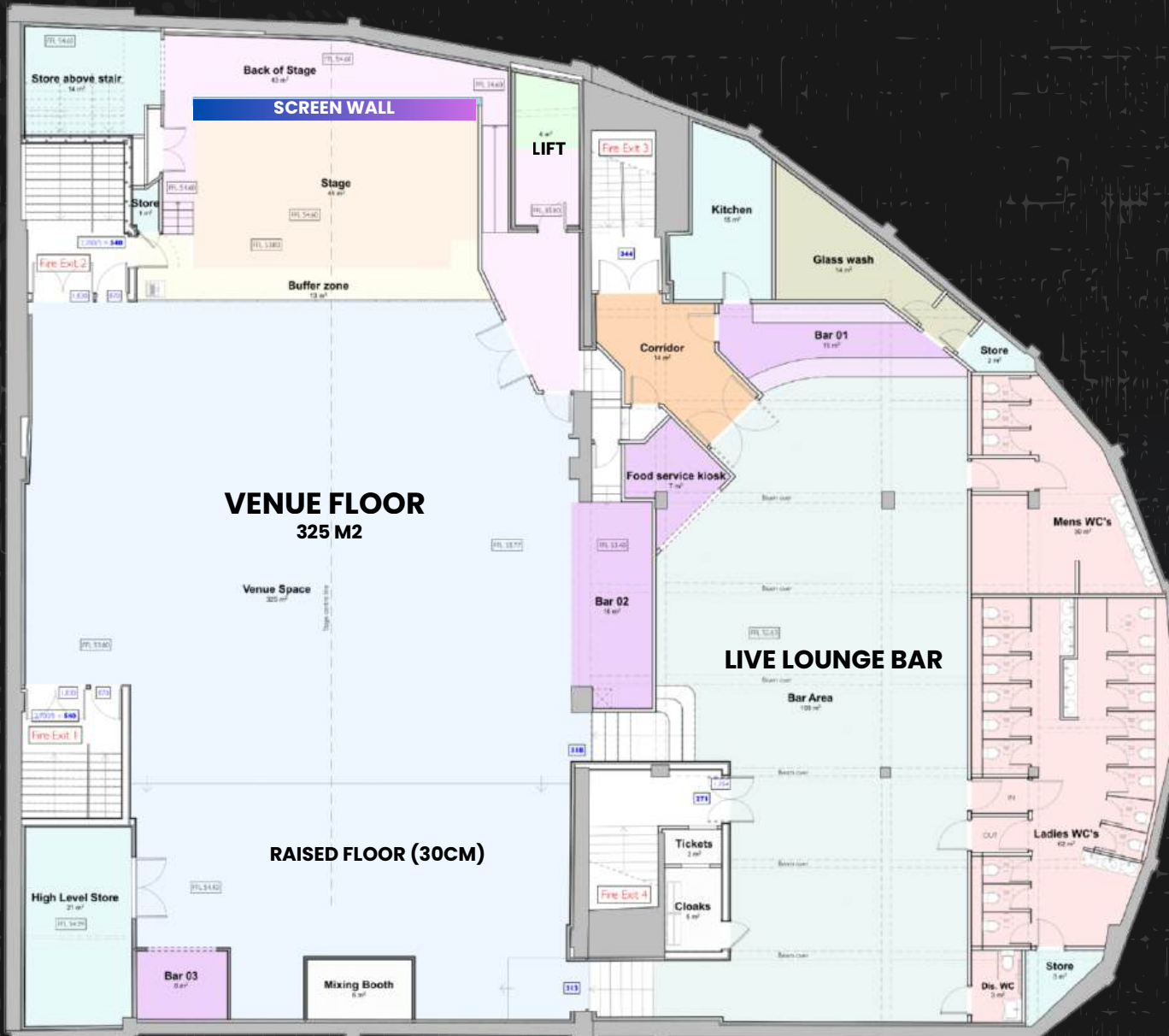











**ARENA**  
TORQUAY

**LIVE LOUNGE BAR ENTERTAINMENT AREA**



**SOUND**

**AUDIO:**

Martin Audio MLA  
Compact three-way  
line array **X6**

Martin Audio DSX  
Twin 18' Subs **X6**

**FRONT & SIDE FILLS:**

Line 212-6 Tops Side Fill **X2**  
SW118 Subs Side Fill **X2**  
E90 Front Fill **X2**

**DELAYS:**

Martin Audio BLACKLINE  
Q 12" **X2**

**FOH:**

Yamaha CL5 + Rio(**SR**)

**DJ:**

Pioneer CDJ3000 **X2**  
Pioneer DJM-900NXS **X1**

**MONITORING**

**DESK (side stage):**

Yamaha QL5 (64  
mono 8 stereo + built  
in Digital Dante)

**WEDGES:**

Kling & Freitag  
Floor wedges **x 10**  
(8 mixes total)

*(The venue does not  
have in-house IEM's  
please provide your  
own)*

**LIGHTING**

**FOH:**

Avolites Tiger Touch 2  
Artnet (8 Port) SR **X1**  
DMX Line Per Truss **X1**

PATCH AVAILABLE UPON  
REQUEST

**LIGHTING:**

Chauvet Colorado **X20**

BeamZ MHL760 **X12**

BeamZ Ignite 220 **X12**

BeamZ SB220IP Blinder  
**X9**

BeamZ BS1100IP Strobe  
**X9**

**SCREEN**

**CONTROL**

Novastar MCTRL600  
Calibre 530 Scaler /  
Input Switcher HDMI

Input **SR & FOH**

**SCREEN**

Absen A3 **6m x 3m**

**NOTES**

All content scaled  
from 1920 x 1080  
through calibre.

*(Screen is to be used  
in place of any  
backdrops)*

**POWER**

**SR:**

32A3ph/100mA **X1**

32A1ph/30mA **X2**

16A1ph/30mA **X2**

**SPEAKER STACK PIT:**

16A1ph/30mA **X2**

**STAGE FLOOR**

13A Sockets **x12**

**FOH:**

13A Sockets **X 14**

**MICROPHONES**

**Microphones**

Sennheiser G3 HH

Wireless **x4**

Sennheiser G3 Lapel

Wireless **x4**

Vast range of Wired  
Shure/Sennheiser  
Microphones (vocals,  
Full drums, cabs etc)

**CABLE WORK**

Cable Tray from FOH  
to Stage (**50m**  
**Approx**)

**STAGE BOXES**

14 way stage box  
with 12in/2out **x4**

Equipment load in for Arena Torquay is located on a large but quiet road at the rear of the venue using two different access options:



### LOADING IN

#### **LIFT LOAD IN:**

The rear of the venue has double door access opposite the church which ramps down avoiding use of any stairs directly into a goods elevator with a floor space of 2m x 2m and a maximum load of 500kg which crew can use to transport bulkier gear directly to back stage and stage left level. We recommend having a member of crew at the top whilst someone loads the lift below as nobody is permitted to ride with the equipment.

Coaches and splitter vans can mount the curb and park tightly against the black wall next to our rear access doors and load in from there. Coach power is available by the load in doors. If additional power is required then we also have power outside our box office lounge bar, The power is 32 amp 3-phase, please provide your own leads.

#### **FIRE EXIT LOAD IN:**

5m across from the lift load in doors is a large double fire exit with a 4.5m staircase which comes out on stage right at pit barrier level – equipment can then be lifted on to the stage or taken up the stage right steps.



### LOADING OUT

Load out can be achieved through either method used for loading in.



*(We can reduce room size down to 500 cap for smaller shows using curtains)*

### HIRE

FULL CAPACITY: 1175

**£995 + VAT + PRS**

500 CAPACITY OR LESS:

**£500 + VAT + PRS**

\*All additional fees, levies and commissions are detailed in our contracts of engagement.

#### INCLUDES:

- 1 x Sound Engineer (8 hrs included - **£28.00 + VAT p/h per person after this time frame**)
- Use of in-house systems & LED screen
- Box office staff
- Duty Manager & Bar Staff
- Green Room & Dressing Rooms access

#### EXCLUDES:

- Security (**£23.00 + VAT p/h - 1 x security staff is required per every 100 ticket holders**)
- Lighting Engineer - **£300 + VAT**

#### EXTRAS (if required):

- Crew/Runners - **£18.00 p/h + VAT per person**
- Towels - **£1.50 each (£1.50 charge for every towel not returned)**
- Rider - **Promoters responsibility**
- Press/Meta Ads - **Charged at cost**
- Merch Seller - **£18.00 + VAT p/h per person**
- Extra Engineers - **£28.00 + VAT p/h per person**
- Tour Bus Power - **£100 + VAT**

### TICKET SPLIT

**80/20 + VAT + PRS**

Any 80/20 split deal in your favour is after venue costs. All additional fees, levies and commissions are detailed in our contracts of engagement.

#### INCLUDES:

- Use of in-house sound systems, lighting & LED screens
- Box office staff
- Duty Manager & Bar Staff
- Green Room & Dressing Rooms access

#### COSTS BEFORE SPLIT:

- Sound & Lighting Engineer: **£600+VAT**
- Security (**£23.00 + VAT p/h - 1 x security staff is required per every 100 attendees**)
- PRS (**4.2% of NET Receipts**)
- Marketing Contra: **£300+ VAT**

#### EXTRAS (if required):

- Crew/Runners - **£18.00 p/h + VAT per person**
- Towels - **£1.50 each (£1.50 charge for every towel not returned)**
- Rider - **Basics Provided by us (Water, Beers, Tea & Coffee facilities)**
- Press/Meta ads - **Charged at cost**
- Merch Seller - **£18.00 + VAT p/h per person**
- Extra Engineers - **£28.00 + VAT p/h per person**
- Tour Bus Power - **£100 + VAT**



## HIRE

**£300 + VAT + PRS**

\*All additional fees, levies and commissions are detailed in our contracts of engagement.

### INCLUDES:

- PA Hire & 1 x Engineer
- Use of in-house stage Deck & lighting rig
- Green Room & Dressing Rooms access
- Box office staff
- removal of furniture (if required)

### EXTRAS (if required):

- Crew/Runners – **£18.00 p/h + VAT per person**
- Security – **£23.00 p/h + VAT per person**  
**(2 x SIA Security staff are mandatory after 9pm)**
- Towels – **£1.50 each (£1.50 charge for every towel not returned)**
- Rider – **Basics Provided (Any advanced catering will be charged at cost)**
- Press/Radio/Billboard – **Charged at cost**
- Merch Seller – **£18.00 + VAT p/h per person**



## HIRE

**£250 + VAT**

\*All additional fees, levies and commissions are detailed in our contracts of engagement.

### INCLUDES:

- Use of built in PA system (speech or performance) PRS Fees will apply to any performance.
- Room set-up (signing tables, meet & greet)
- 1 x member of bar staff

Our brand new Box Office Lounge Bar is the perfect location for bringing added value to your show at the venue - as well as general admission tickets you can offer a relaxing space for a V.I.P meet & greet option, merch signing or an intimate exclusive acoustic performance for V.I.P fans before or after the main show.

At Arena Torquay the comfort and privacy of our visiting artists and their production teams are very important to us. Our Private facilities consist of **Dressing room 1** for our headliners & **Dressing Rooms 2 & 3** for support acts or crew all with en suite toilet & shower facilities. We also have a large communal green room for relaxing in and access to an artist & crew kitchen.

### DRESSING ROOMS

All three private dressing rooms in the venue have the below features:



Large Fridge



Large TV & Firestick etc



Sofa & Seating areas



Private shower & toilet



Wardrobes

### TOILETS & SHOWERS

All dressing room bathroom facilities in the venue have the following:



1 x Toilet



1 x Shower



1 x Sinks



Fresh Towels (if ordered)



Soap & Handwash

### THE GREEN ROOM

We have a large communal green room next to the dressing rooms with the following:



Large Table & Chairs



Large TV, Games Console & Firestick



Sofas & Seating areas



Tea & Coffee Facilities



Games





**DRESSING ROOM 2 - "BRIXHAM"**



**DRESSING ROOM 3 - "PAIGNTON"**



### DIRECTIONS FROM TORQUAY HARBOUR

- When exiting the dual carriageway for Torquay continue until you start seeing signage for “sea front” or “harbour” and follow them.
- Once you have passed The princess theatre on your right take the first left at the roundabout and follow the road until you see the clock tower.
- Take the first left at the clocktower and continue up the hill to the traffic lights, Arena Torquay will be in front of you on the right-hand side

### DIRECTIONS FROM BABBACOMBE

- If you came via the coast road then continue through Babbacombe following the signs for the “sea front” or “harbour”
- Once you see the bowling alley on your left-hand side you will see that Arena Torquay is just two buildings down from there.

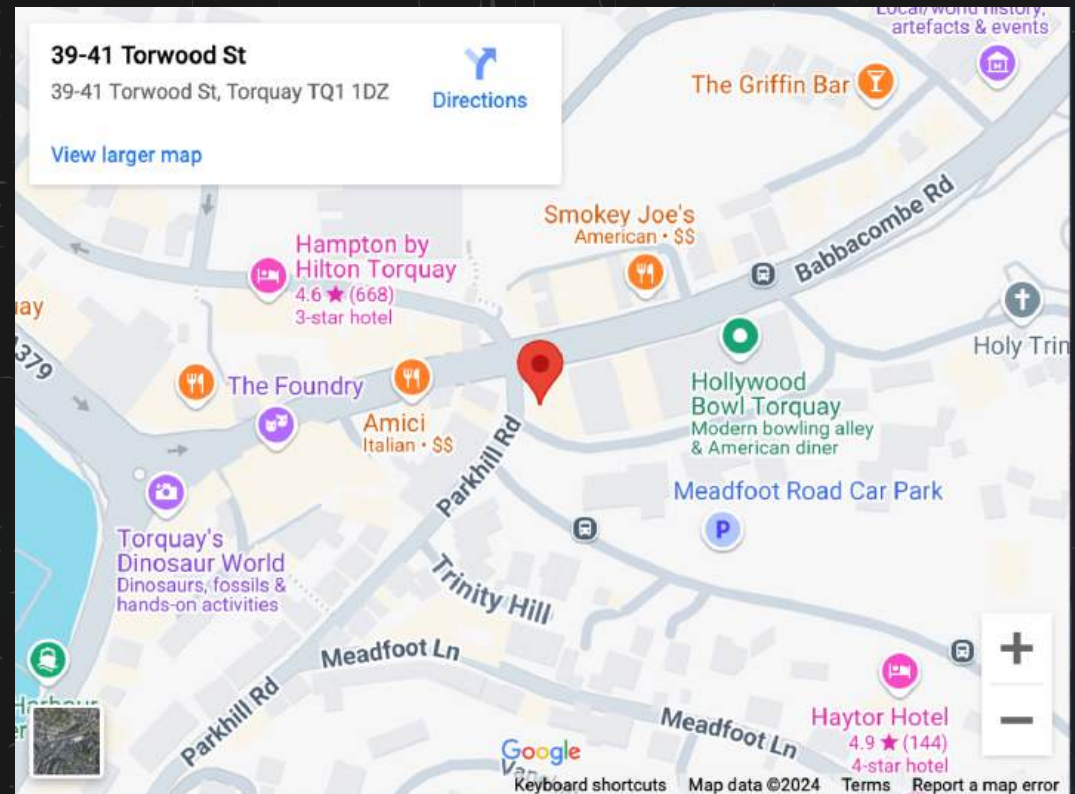

### ADDRESS:

ARENA TORQUAY, 39-41 TORWOOD STREET,  
TORQUAY, DEVON, TQ1 1DZ

### LOAD IN ADDRESS (Artists/Crew):

TORWOOD GARDENS ROAD, TORQUAY, TQ1 1EJ



**HOSPITAL**

**Torquay Hospital**  
Newton Road, Torquay  
TQ2 7AA

**Distance from venue:**  
3 miles



**AIRPORTS**

**Exeter Airport**  
Exeter, Devon EX5 2BD

**Bristol Airport**  
Bristol Airport, Lulsgate  
Bottom, Bristol BS48 3DY

**Distance from venue:**  
Exeter - 26.9 miles  
Bristol - 87 miles



**HOTELS**

**Hampton by Hilton**  
The Terrace, Torquay  
TQ1 1DP

**Premier Inn**  
Montpellier Road,  
Torquay TQ1 1DL

**Distance from venue:**  
Both 440 feet



**TAXIS**

**Torbay Cab Company**  
01803 292292

**Torbay Taxis Ltd**  
01803 211611

**1st Class Cars**  
01803 211611

**Nearest Taxi Rank:**  
213 feet

**RESTAURANTS**

**Thai:** Jun Jaow Thai Restaraunt  
**Distance From Venue:** Next Door

**Indian:** East in the West  
**Distance From Venue:** Next Door

**Italian:** Amici's Italian Restaurant  
**Distance From Venue:** (213 feet away)

**Chinese:** Tang Tang Chinese Restaurant  
**Distance From Venue:** Opposite us (30 feet)

**Steak:** Smokey Joe's Steak house  
**Distance From Venue:** Opposite us (30 feet)

**Advance Bookings:**  
If you require table bookings or takeaways during your performance date we can make these arrangements if you contact us before your arrival.

# ARENA

T O R Q U A Y



[info@arenatorquay.com](mailto:info@arenatorquay.com)



[www.arenatorquay.com](http://www.arenatorquay.com)



[@arenatorquay](#)